

## ROCKER SWITCH MODEL MR2 SERIES

RATING:10(4)A 125/250V~T55 (cURus/ENEC15)

DIELECTRIC VOLTAGE-WITHSTAND:1,500VAC FOR 1 MINUTE

INSULATION RESISTANCE:DC 500V 100M $\Omega$  (MIN.)

CONTACT RESISTANCE:20m $\Omega$  INITIAL (MAX.)

WATERPROOF GRADE:IP68

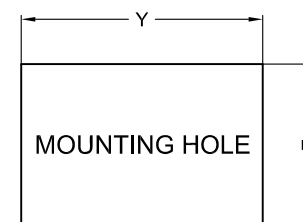
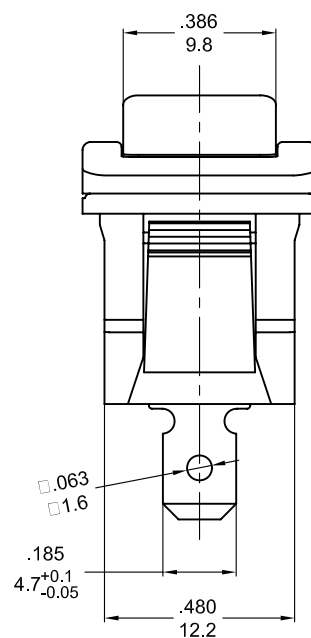
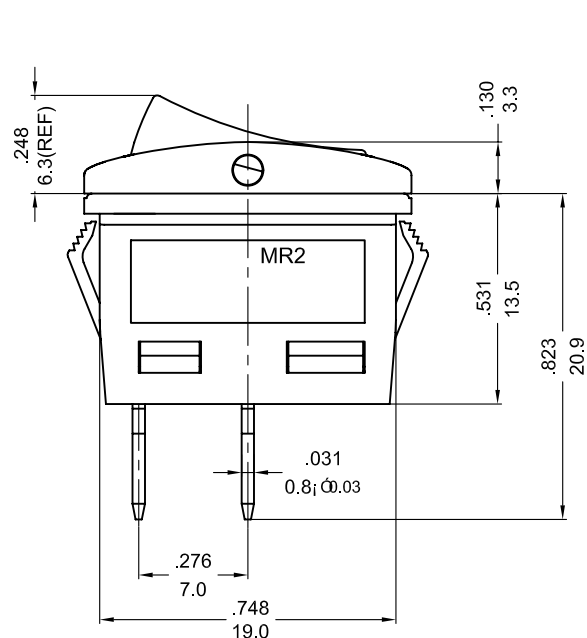

X(PANEL THICKNESS)	Y(CUTOUT DIMENSION)	Z(CUTOUT DIMENSION)
0.75~1.25mm	19.2 <sup>+0.1</sup> <sub>-0</sub> mm	12.9 <sup>+0.15</sup> <sub>-0</sub> mm
1.25~2mm	19.4 <sup>+0.1</sup> <sub>-0</sub> mm	12.9 <sup>+0.15</sup> <sub>-0</sub> mm
2~3mm	19.8 <sup>+0.1</sup> <sub>-0</sub> mm	12.9 <sup>+0.15</sup> <sub>-0</sub> mm

PANEL CUTOUT DIMENSION TABLE

NOTE: TOLERANCES UNLESS OTHERWISE SPECIFIED:±.012/0.3 (in/mm)

REVISION	DESCRIPTION	REVISED BY	TOLERANCES	ANGLE $\frac{1}{2}^\circ$	UNIT	mm	PART NAME	MR2 SPEC DRAWING	DWG NO
④			DRAWN BY 楊偉韶	DESIGNED BY 蔡劍	SCALE	2/1	PART NO	SWMR2-110C2N-NBBP-29NC	S8017A
③			CHECKED BY	APPROVED BY	DATE	2020.03.11			
②									
①	2020.03.11 首次出圖	楊偉韶							